

## Solar Pool Heating Standard Plan For One- and Two- Family Dwellings

SCOPE: Use this plan ONLY for solar pool heating systems not exceeding a thermal output rating of 30 kWth on the roof of a one- or two- family dwelling or accessory structure and used for residential solar pool heating. Systems must be in compliance with current California Building Standards Code, Title 24 and local amendments of the authority having jurisdiction (AHJ). Other articles of the California Plumbing Code (CPC) or California Mechanical Code (CMC) or other health and safety codes shall apply.

MANUFACTURER’S SPECIFICATION SHEETS MUST BE PROVIDED for proposed collector, controller, solar pump (if applicable), heat exchanger/heat transfer fluid (if applicable), diverting valve (if applicable) and mounting systems. Equipment intended for use with a solar pool heating system shall be identified and listed for the application.

Job Address: \_\_\_\_\_ Permit #: \_\_\_\_\_

Contractor/Engineer Name: \_\_\_\_\_ License # and Class: \_\_\_\_\_

Signature: \_\_\_\_\_ Date: \_\_\_\_\_ Phone Number: \_\_\_\_\_

Email: \_\_\_\_\_

Total # of Collectors Installed \_\_\_\_\_ Total Collector Area \_\_\_\_\_

Collector Certification Number (include certifying agency) \_\_\_\_\_

Collector Material \_\_\_\_\_

Max Height Above Roof \_\_\_\_\_ Height Above Ground \_\_\_\_\_

### Major components

Solar Control Make/Model \_\_\_\_\_

Solar Pump Make/Model (if applicable) \_\_\_\_\_

Diverting Valve Make/Model \_\_\_\_\_

Mounting Hardware Make/Model or Type \_\_\_\_\_

# SAMPLE ROOF PLAN for SDWH and SPH systems

- ROOF TYPE: STANDING SEAM
- ROOF HEIGHT (Elevation): MAX 15' (1 story)
- RAFTERS: 2" X 6" @ 24" OC



(18) 4'x12' XXX PANELS

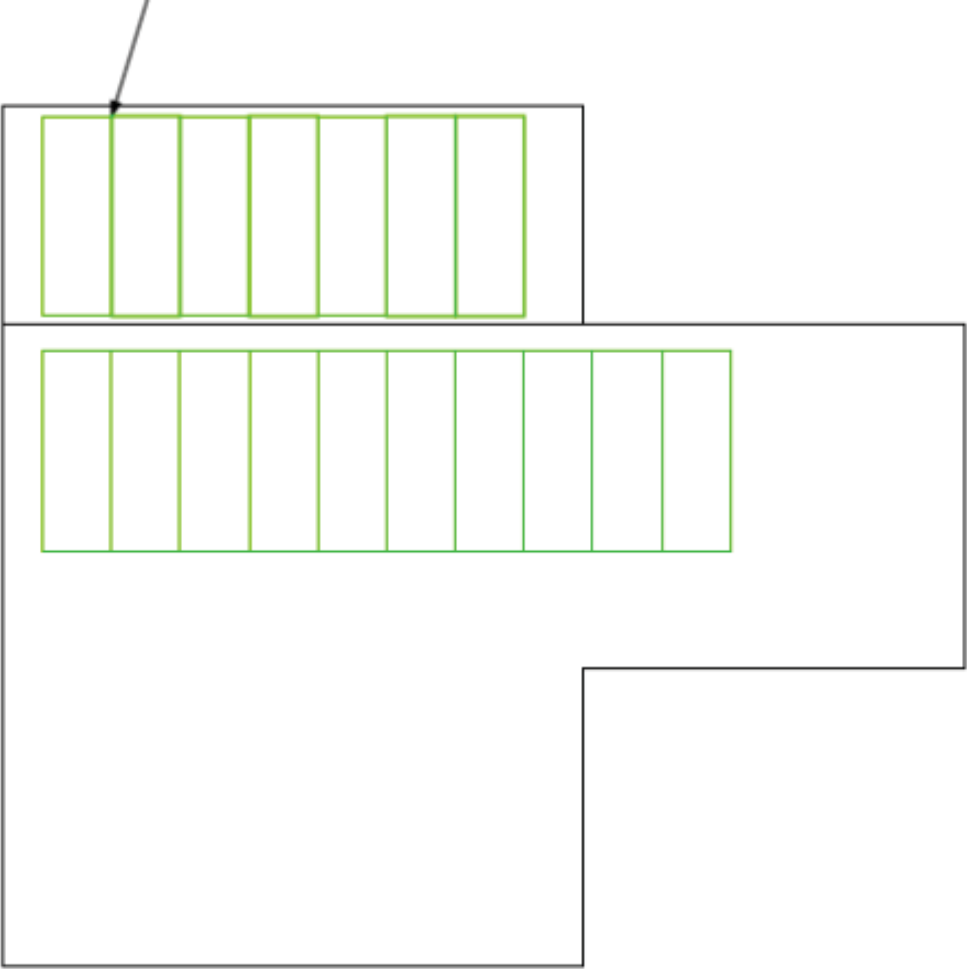

# SAMPLE ONE LINE PLUMBING DIAGRAM

## For SPH Systems

